

STUDENTS SELLING
THEMSELVES

NEWS, page 3

OPEN MIC NIGHTS
GAINING POPULARITY

VARIETY, page 5

The Gustavian WEEKLY

Gustavus Adolphus College's Student Newspaper Since 1891

BASEBALL AND
SOFTBALL PREVIEWS

SPORTS, pages 10 & 11

DEFENDING THE
WHITE RIBBONS

COMMENTARY, page 13

MARCH 17, 2000

[HTTP://WWW.GUSTAVUS.EDU/ONCAMPUS/ADMIN/COLLEGERELATIONS/NEWS/WEEKLY/](http://www.gustavus.edu/oncampus/admin/collegerelations/news/weekly/)

VOLUME 110, NUMBER 18

CAMPUS

All under one roof

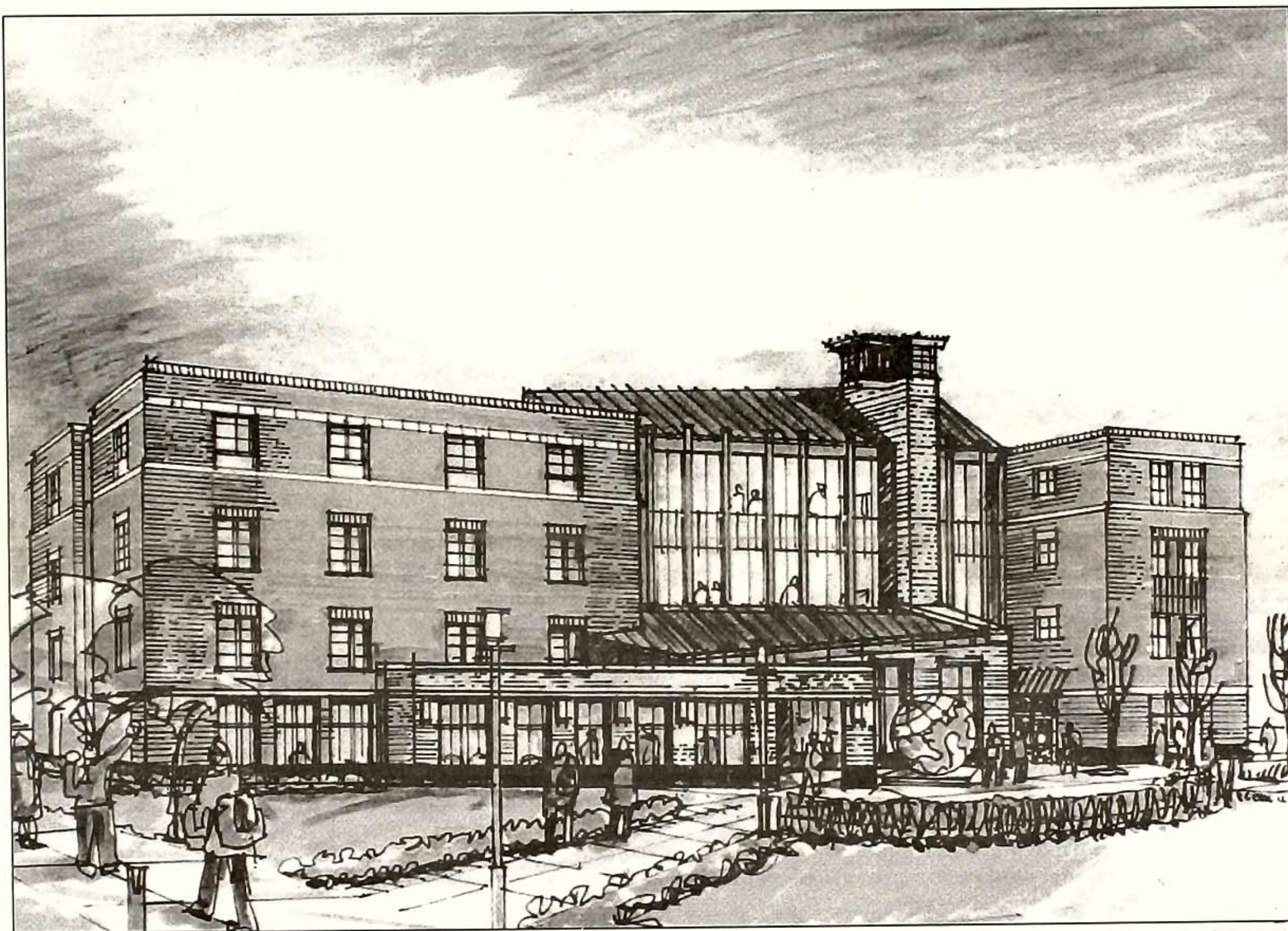

ART SUBMITTED

New dorm behind Olin Hall will combine Crossroads, Swedish House and the International Education Office. Building is slated to be habitable by August.

MARNE GULLEY
Staff Writer

ENHANCING THE CONSTRUCTION motif on campus, crews broke ground for the new international center last week.

The facility, located northwest of Olin Hall, will house the Crossroads program, Swedish House and the Office of International Education.

The four-story Crossroads section will be home for 70 students and the Swedish house, which has two stories, will house 10 students.

According to Hank Toutain, dean of students and vice president for student affairs, the

Crossroads section of the building will feature a large living room with a fireplace, a large kitchen, an apartment for the college's visiting scholar, community rooms and studylounges on each floor.

The Crossroads rooms are arranged in a suite configuration, with various combinations of single and double rooms. Students will share a small common area and bathrooms with fellow suitemates. The building does not include any community bathrooms.

"I love the idea of living in suites," said Junior Becky Smith. "The system is more attractive to independent student-types, such as the [teach-

ing assistants] or the international students."

According to the college mission statement, Gustavus Adolphus "aspires to be a community of persons from diverse backgrounds who respect and affirm the dignity of all people."

Crossroads is an internationally focused residential program that attempts to achieve this mission. It includes international students and the teaching assistants from several countries. Members of Crossroads organize activities to introduce diversity to the campus.

"The new building has a lot of common areas, which help in the integration part of Crossroads," Smith said. "Also, the

main floor has a lot more room for entertaining, dinners and receptions, which we like to do a lot."

Mona Rizk-Finne, director of International Education, described the large central living room as a hub that will bring all three programs together.

The new office of International Education, located on the main floor, will be much larger than the current one in Johnson Student Union.

"It's more space and space that will be open and inviting for all the clientele we serve," Rizk-Finne said. "It will be a better facility to conduct our work and better serve our stu-

dents. When we're crammed, it's hard to create a welcoming, conducive environment."

The new building reflects Gustavus' commitment to international education, according to Toutain. "The point of the building, in addition to providing some needed housing space, is that it is an opportunity to make a visible statement with regards to an important aspect of our mission statement," Toutain said. "We think this is an opportunity to feature and promote a broader and more dynamic international program."

Freshman Sandy Valnes,

NEW, PAGE 4